

Installation Instructions for Catalog # 81099  
**MAGNUM GRIP SHIFTER HANDLE**  
 for 2016-2018 TOYOTA TACOMA  
 w/AUTOMATIC TRANSMISSION

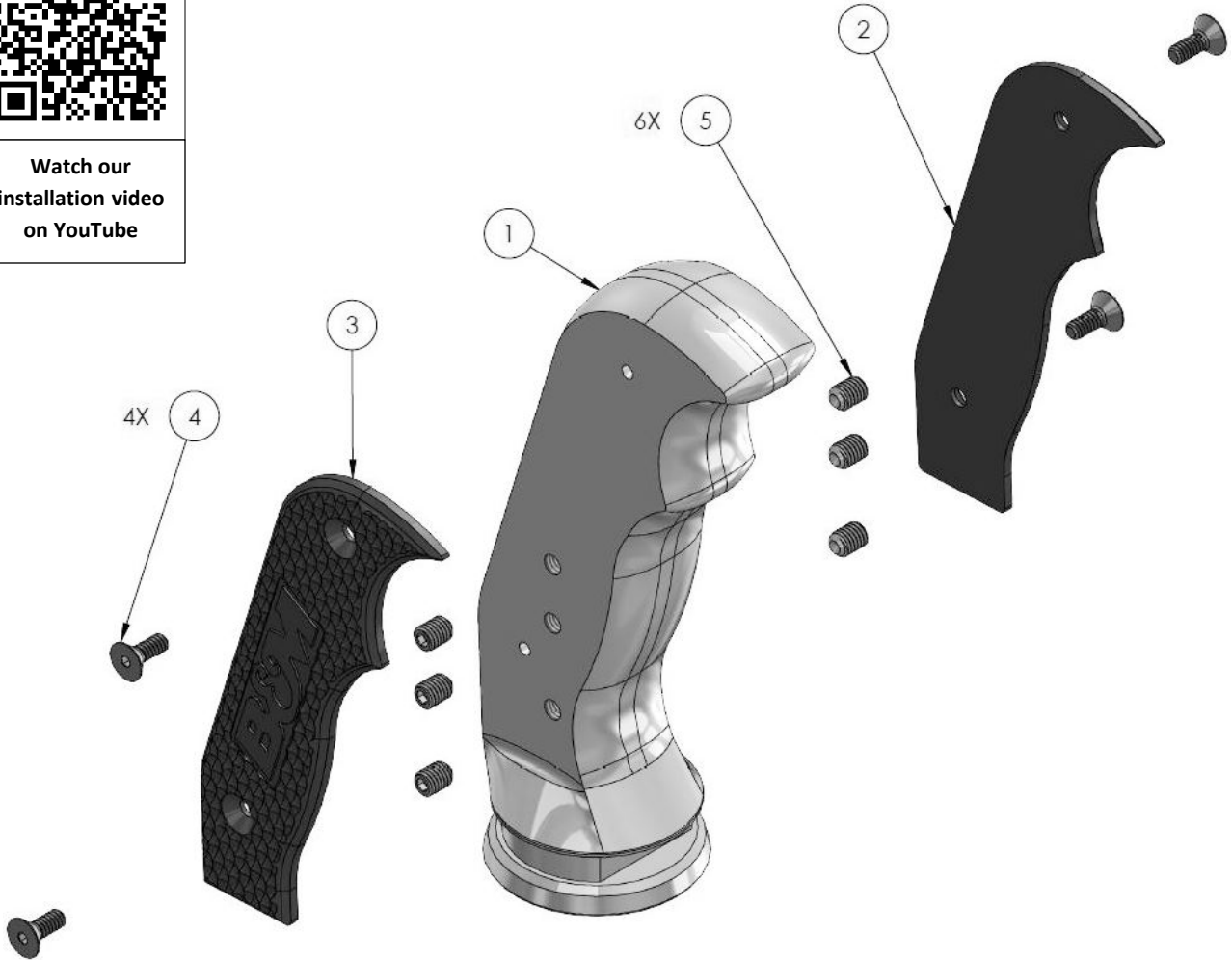

Watch our  
 installation video  
 on YouTube



| ITEM NO. | PART NO. | DESCRIPTION                                       | QTY. |
|----------|----------|---|------|
| 1        | 4001723  | MAGNUM GRIP SHIFTER HANDLE BODY, 16-17 TACOMA     | 1    |
| 2        | 4001492  | SHIFTER HANDLE COVER, LEFT, DIAMOND KNURL, BLACK  | 1    |
| 3        | 4001495  | SHIFTER HANDLE COVER, RIGHT, DIAMOND KNURL, BLACK | 1    |
| 4        | 3401294  | SCREW, FLAT HEAD, ALLEN DRIVE, 6-32 × 3/8"        | 4    |
| 5        | 3401547  | SET SCREW, CUP POINT, 10-32 × 1/4"                | 6    |
| [N/A]    | 3290001  | CABLE TIE, 11" × 3/16" [NOT SHOWN]                | 1    |

## BEFORE STARTING

- Take a moment to read and understand these instructions before installing your B&M Magnum Grip Shifter Handle.
- Use the parts drawing and list (front page) to verify your kit's contents. In the unlikely event of missing parts, please contact B&M Technical Support for replacements.
- We highly recommend that you retain all factory parts.
- Work safely! Turn off your vehicle's ignition and set the parking brake.

## REMOVE THE STOCK SHIFTER HANDLE



1. Separate the trim ring from the shifter handle by pushing down on both sides of the shifter boot. Then rotate the shifter handle counter-clockwise to remove it from the stick.

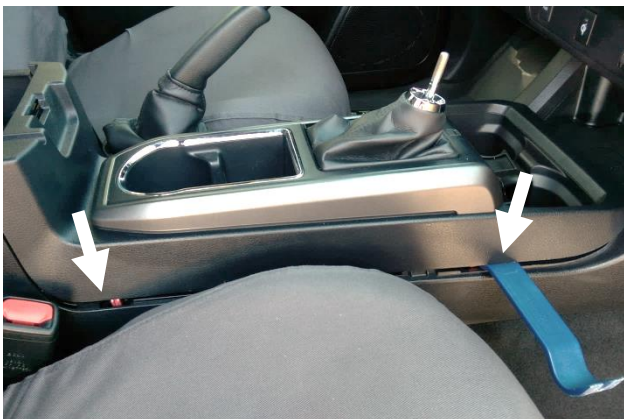

2. Open the center console storage compartment lid and fully engage the parking brake. Then use a plastic trim tool to carefully separate the center console from its base.



3. On the passenger side of the console, find and disconnect the electrical connector. Then lift the shifter boot off the shifter stick. **NOTE:** Leave the emergency brake connected to its boot.

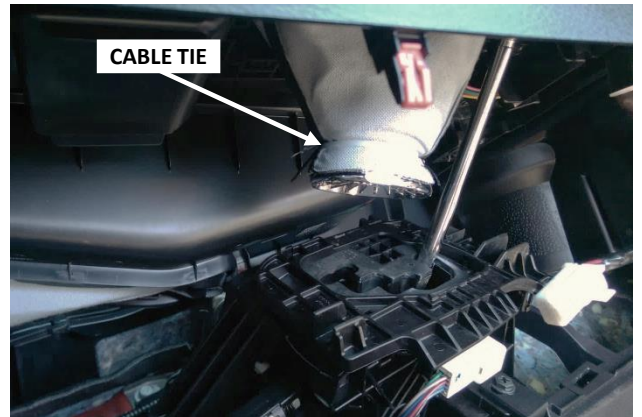

4. Push the shifter boot to underneath the console. Cut the cable tie securing the trim ring in the shifter boot and remove the ring.

## INSTALL THE B&M SHIFTER HANDLE

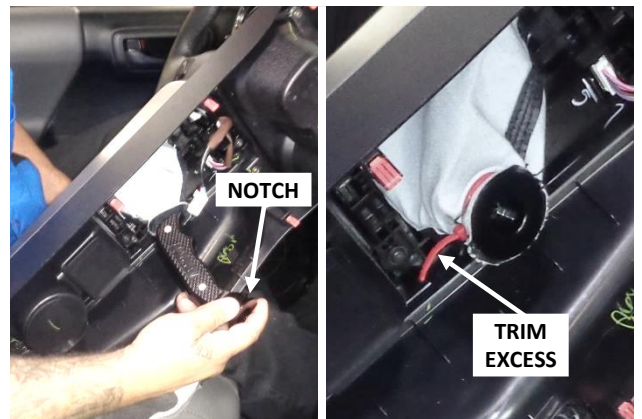

5. Work the shifter handle (item 1) up through the boot until the its opening surrounds the notch at the base of the handle. Use the supplied cable tie to secure the boot to the handle. Trim the cable tie.



6. Carefully lower the shifter handle over the shifter stick. Reconnect the electrical connector, then snap the center console back into its base.



7. Install the six set screws (5) in the shifter handle – three screws on each side. Align the handle as desired, then tighten the set screws.



8. Install the two shifter handle covers (2) and (3) using the four flat head screws (4) – two screws on each side.



**Congratulations, the installation of your B&M Magnum Grip Shifter Handle is now complete!**